



CLUB DE GOLF LOS LEONES

LAS CONDES - SANTIAGO - CHILE

SITE REPORT FOLLOWING VISIT IN OCTOBER 09

ADAM GOLF DESIGN
ARQUITECTOS DE CANCHAS DE GOLF

HOLE N° 18 - EXISTING



At present from the tee on this particularly short Par 5, 511 yards, the first fairway bunkers on the left hand side behind the trees are not clearly visible, whilst those to the right have little visual impact, limiting their strategic value. From the first landing area, the green complex and the corresponding bunkers are not visible, being below the players sight line. Player movement on the putting green and the footpath to the rear are highly distracting for all those playing the hole. Player movement is also visible on the 9th green while playing towards the green.

Preliminary comment: Upon analysis of the hole, we concluded that it was not worth trying to lengthen the hole by 65 yds by locating the future green on the existing putting green. The main reasons being that extra length was only going to concern the very best players, that the existing putting green has an important social role for the members as a meeting point, and that these features created animation for those viewing from the terrace of the club-house.

HOLE N° 18 - PROPOSED



We are proposing that the fairway bunkers become more visible and that their location and design be analysed in greater depth so as to improve the strategy of the hole. We have located the green in roughly the same area, but have raised it by 0.70 m, so that it is much more visible. We have also increased the size of the green from 438 m² to 616 m². The design intent is to create a more varied putting surface as well as an enhanced number of pin positions with a range of difficulty. A third of the green is accessible with a pitch and run, so as to not overly penalize high handicap players. The bunkers have been reduced in size, but by making the back bunker higher than the putting surface, the right hand side of the green will appear significantly more difficult. That area of the green will appear squeezed between two bunkers. Mounding has been added behind the green to screen the putting green from the players view and to separate the green from the putting green. The main water pipe going across the back of the green shall be under very little mounding. A path has been added between the back of the green and putting green permitting player movement from the 9th green to the 10th tee. The putting green has been increased in size from 453 m² to 876 m². The intent is to have a much more varied putting surface to make the putting more fun and to help in its maintenance. A greater surface will help reduce its compaction, general wear and will allow for more pin positions as well. We have also proposed the positioning of a small back tee for hole n°10, 70 m², that can add length to the hole and create some new animation for those viewing from the terrace. Between the putting green and the new back tee of the 10th we are proposing to add low lying flowering vegetative cover. During the design process, we have always kept in mind the importance of the view from the terrace of the club house, and we feel that these proposed modifications enhance visually the general area, and re-enforce the animation around the club house.

EXISTING VIEW FROM THE BACK TEE - HOLE N°18



PROPOSED VIEW FROM THE BACK TEE HOLE - N°18



EXISTING VIEW FROM THE 1ST LANDING AREA - HOLE N°18



PROPOSED VIEW FROM THE 1ST LANDING AREA - HOLE N°18



EXISTING VIEW BETWEEN THE 1ST AND 2ND LANDING AREA - HOLE N° 18



PROPOSED VIEW BETWEEN THE 1ST AND 2ND LANDING AREA - HOLE N° 18



EXISTING PLAN OF THE 18TH GREEN AND PUTTING GREEN AREA

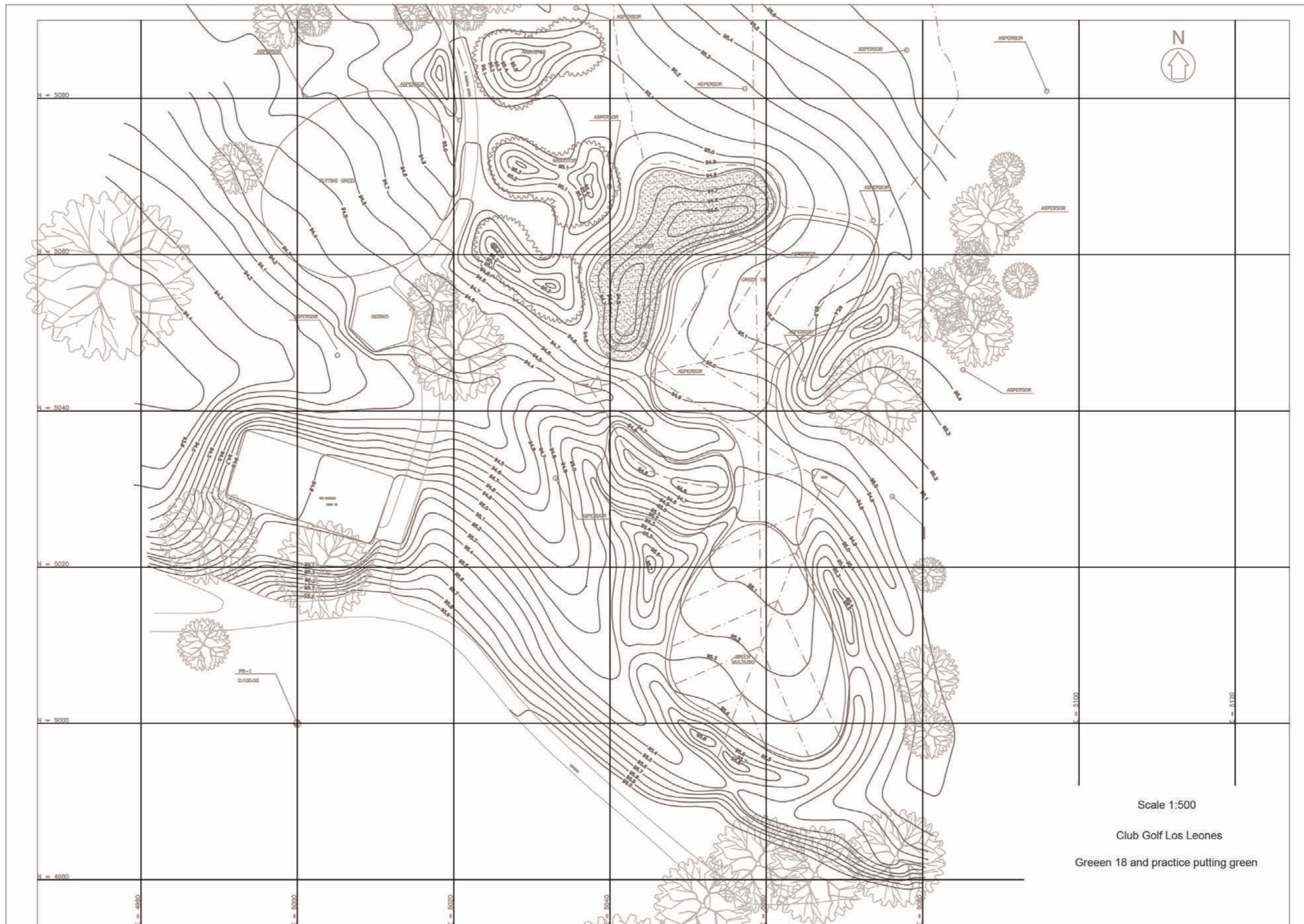

PROPOSED PLAN OF THE 18TH GREEN AND PUTTING GREEN AREA

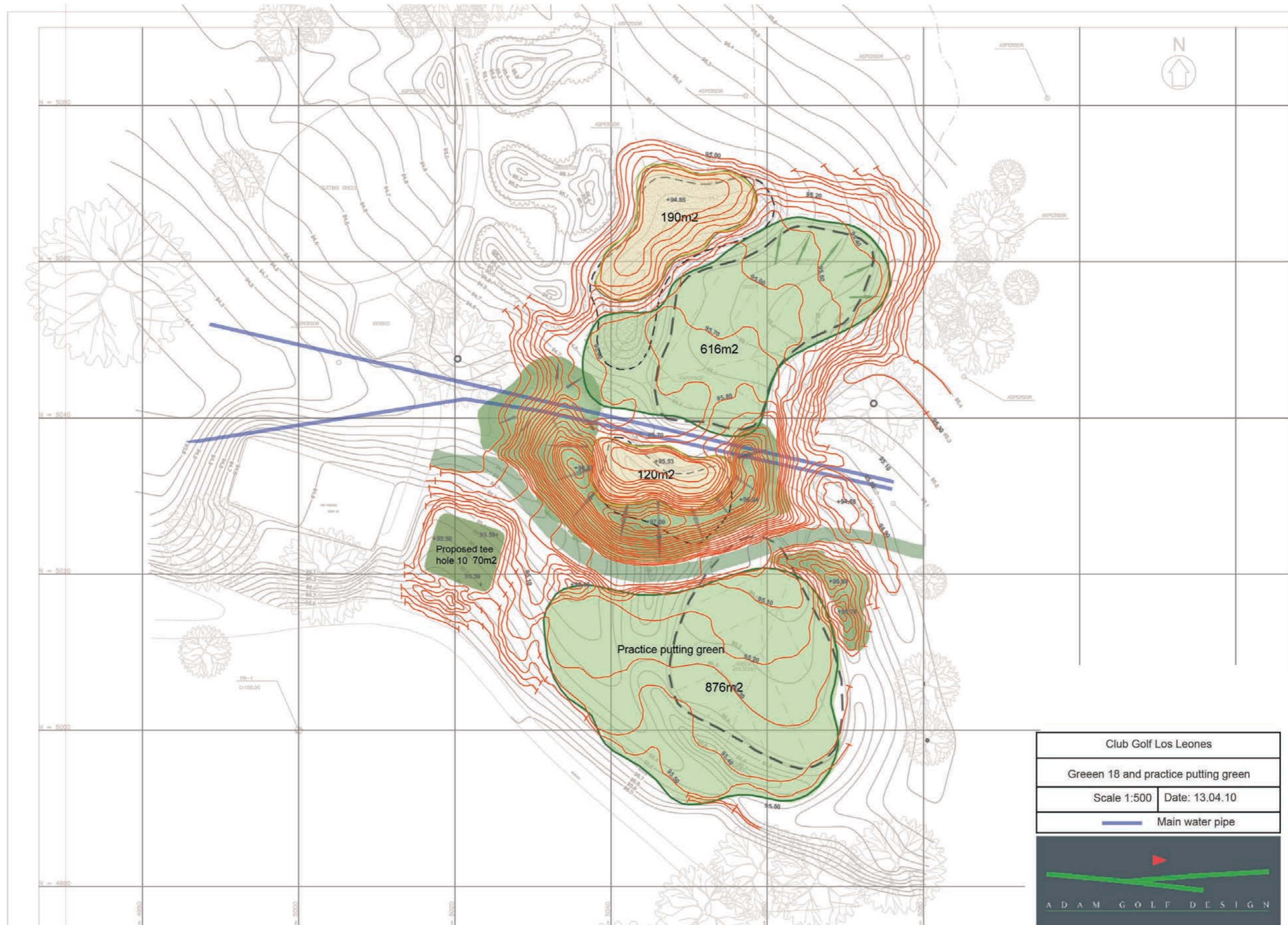

EXISTING PANORAMIC VIEW FROM THE CLUB HOUSE - HOLE N°18



PROPOSED PANORAMIC VIEW FROM THE CLUB HOUSE - HOLE N° 18

